

# ASSEMBLY INSTRUCTIONS

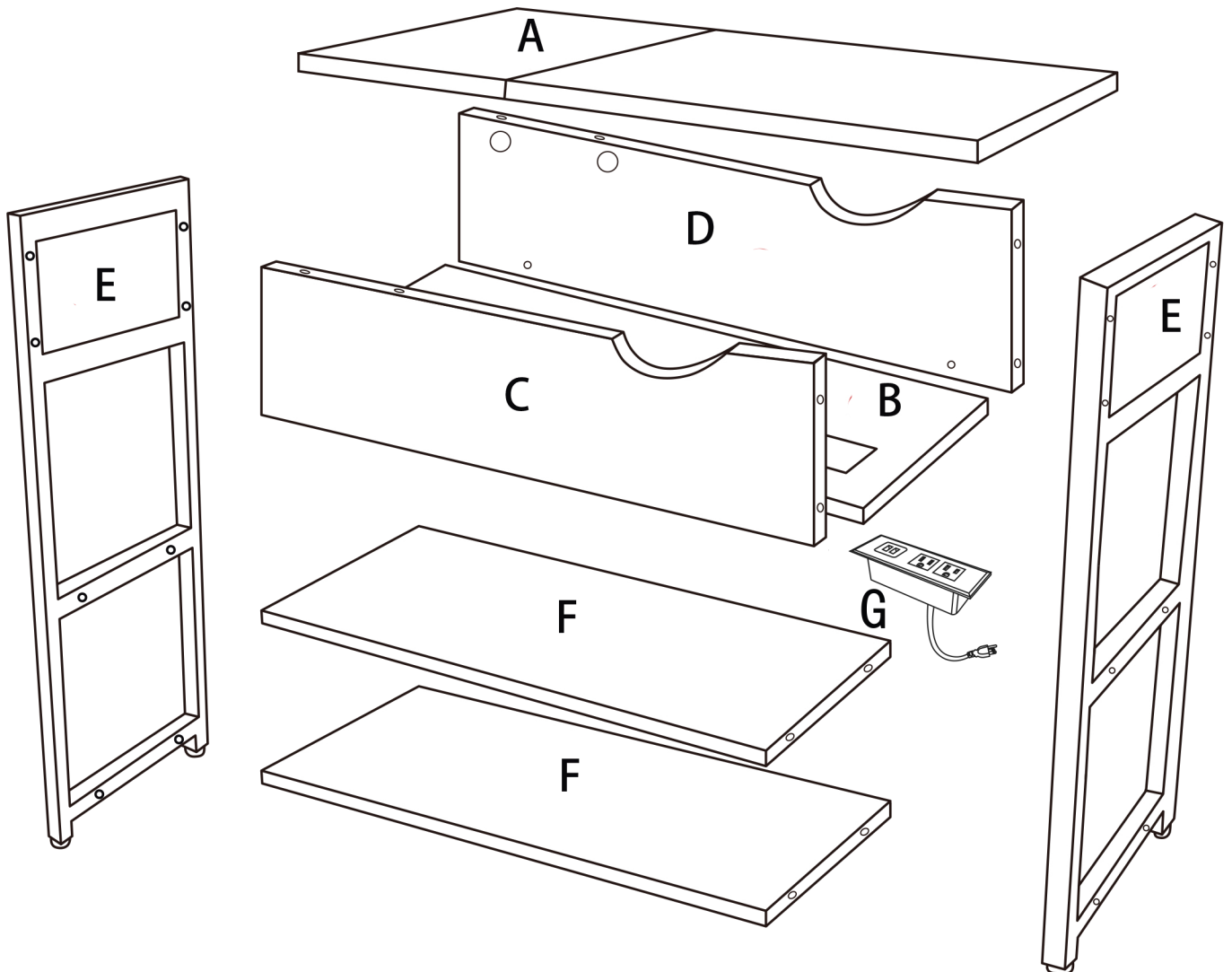

## Product components



## Accessories list

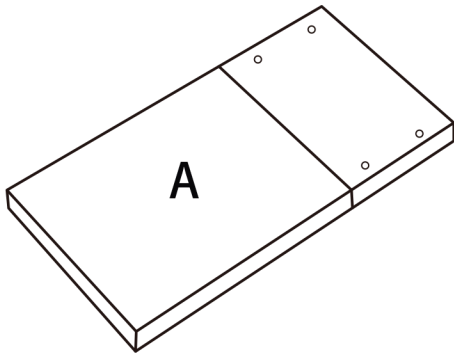
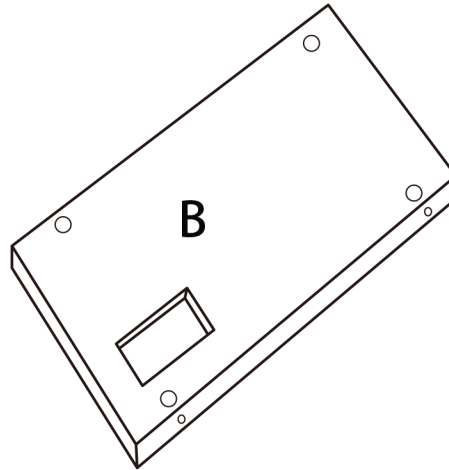
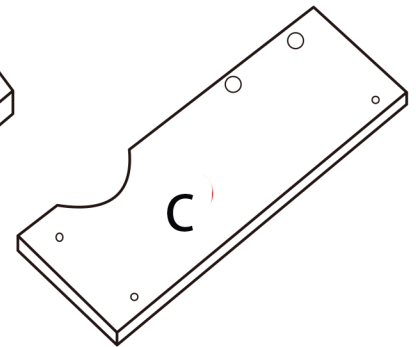

table top x1



floor board x1



Right side board x1

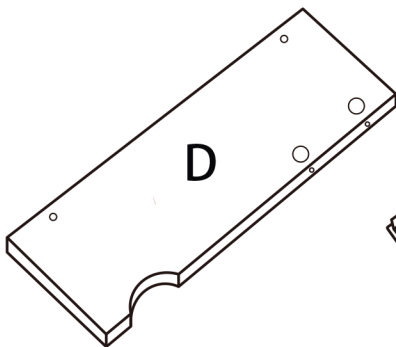

Left side board x1

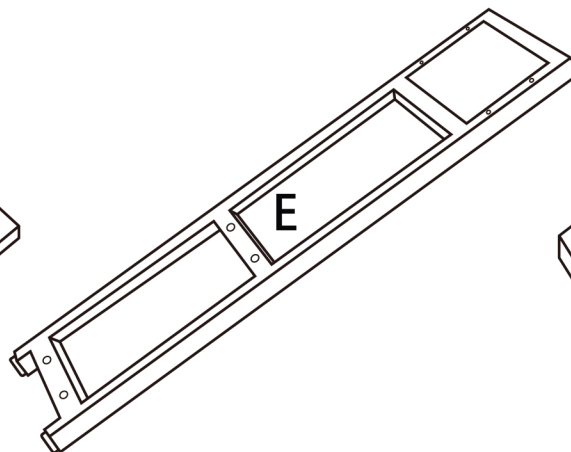
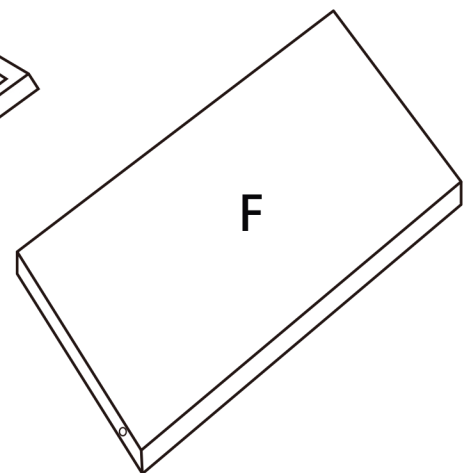
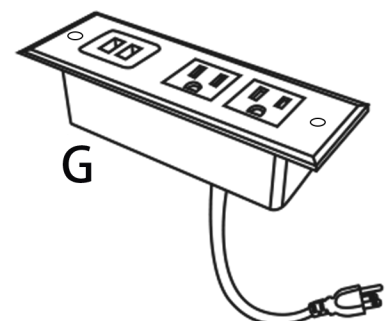
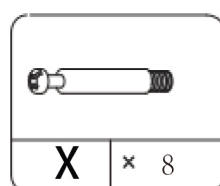
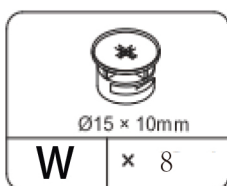

table leg x2



Board x2



Electricity board x1

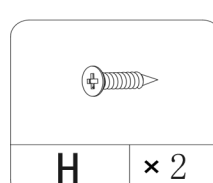
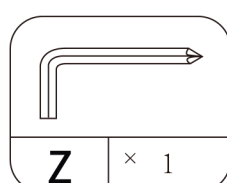
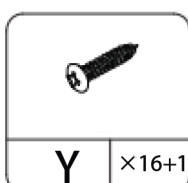

# STEP 1

## preparation

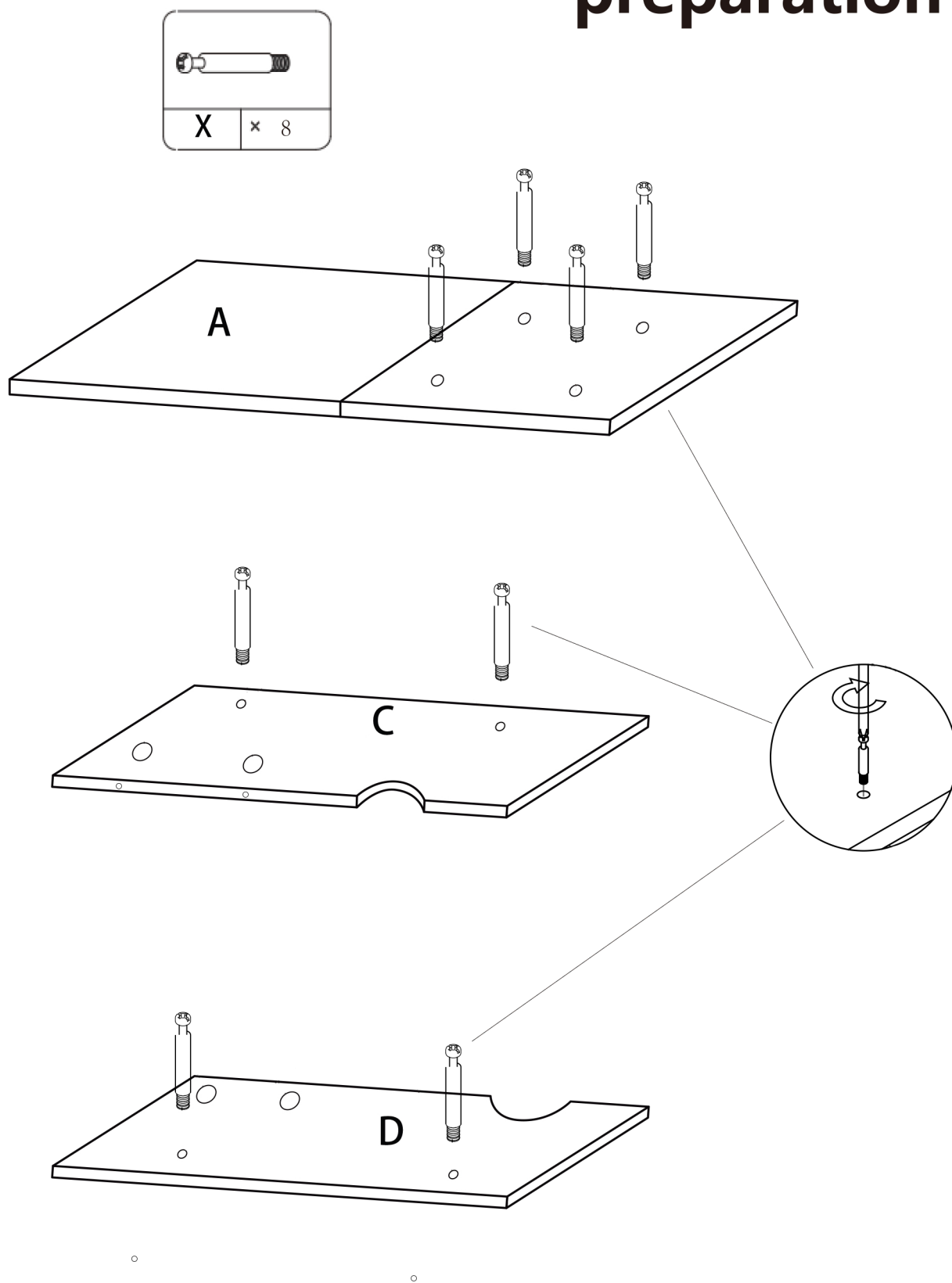

## STEP 2

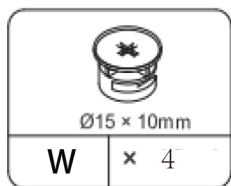
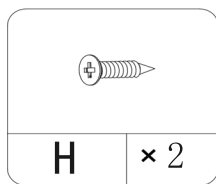
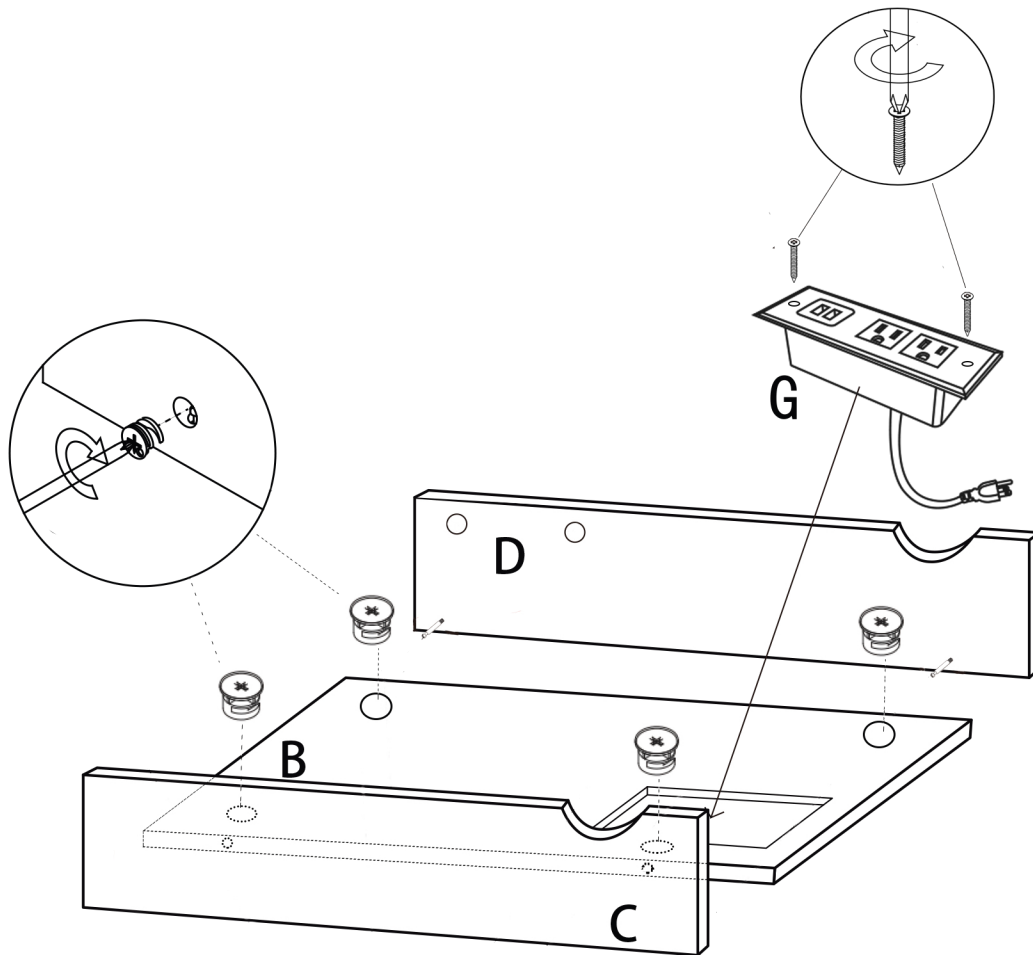

Push a CAM LOCK into the part  
The arrow in the CAM LOCK  
must point toward the hole on the  
edge of the board

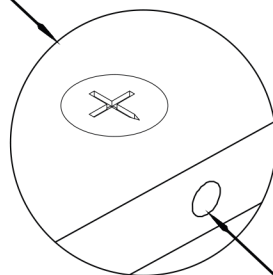

HOLE

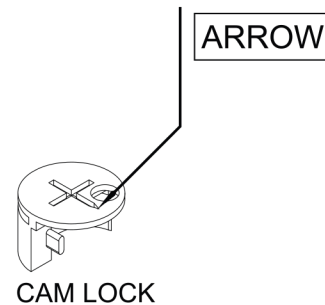

## STEP 3

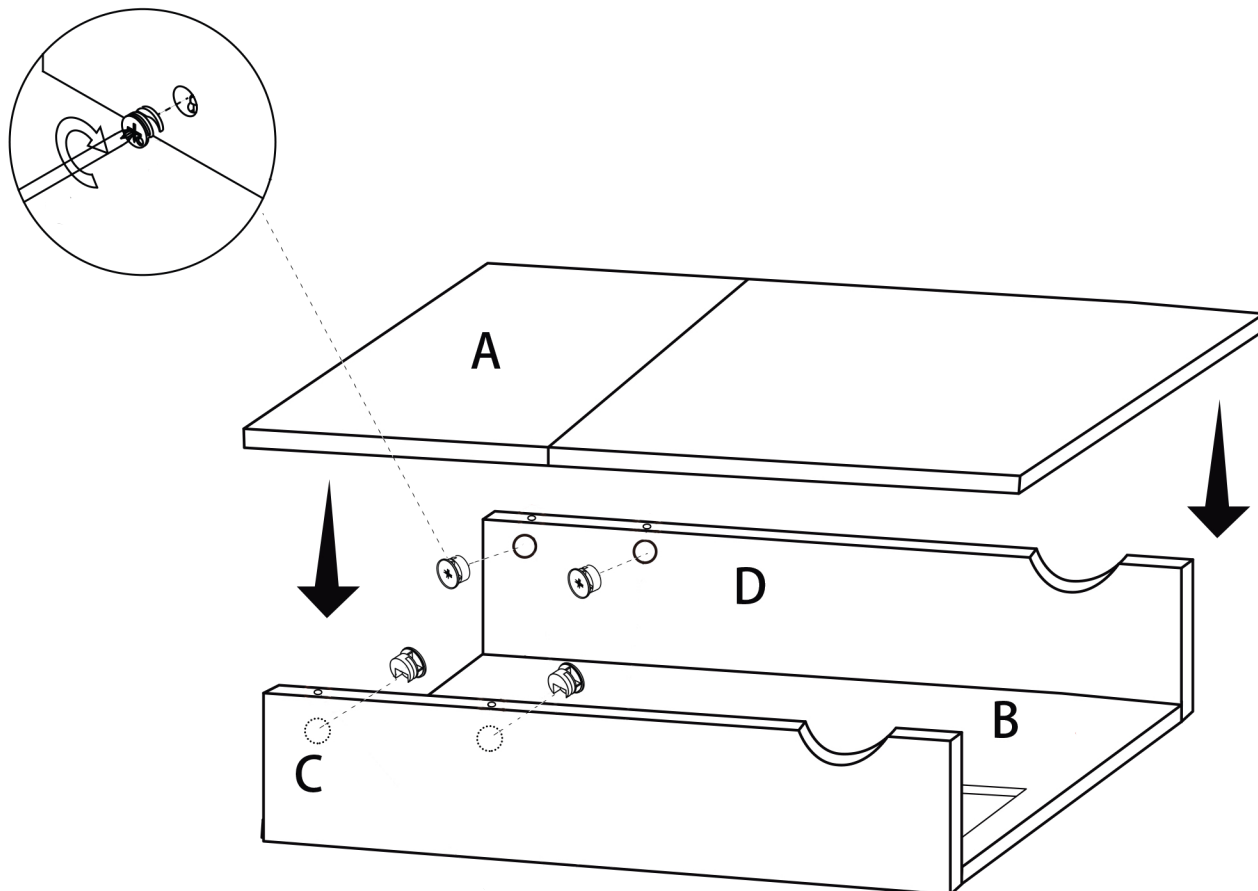

Push a CAM LOCK into the part  
The arrow in the CAM LOCK  
must point toward the hole on the  
edge of the board

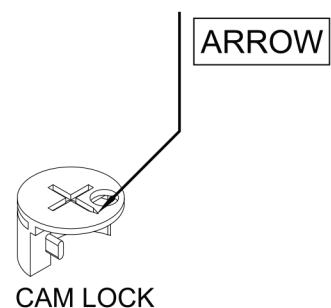
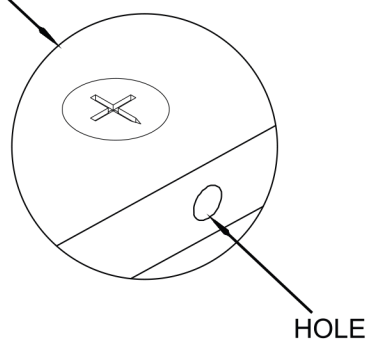
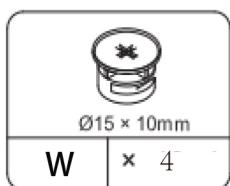

# STEP 4

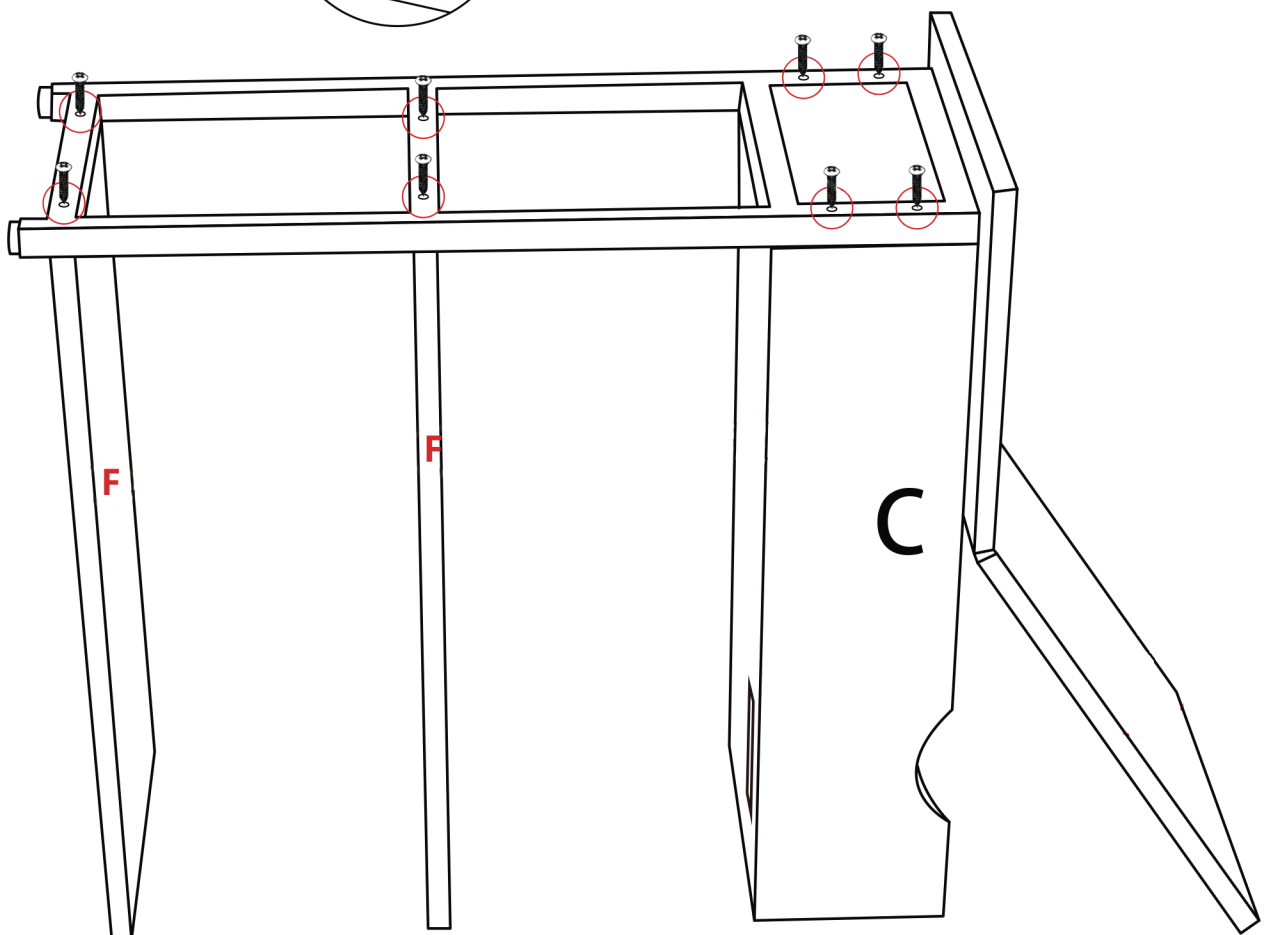
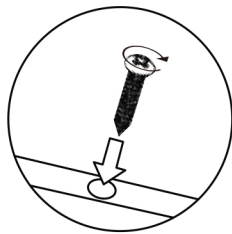
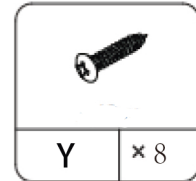

# STEP 5

